

## Factory Service

---

Ad Inflatable™ displays have a one-year, limited warranty (see page 1) covering defective materials or workmanship. Should your display need service or maintenance performed at the factory, please contact your *Pioneer® Line* representative.

A Return Authorization Number is required and can be obtained from your *Pioneer Line* representative. You must provide the serial number of your Walking Ad Inflatable display (located on the battery harness and on an inside tag located near the zipper).

## Trouble Shooting

---

### *Walking Ad Inflatable™ display is not fully inflating:*

- ❶ Ensure the air duct is properly inserted in the air intake opening.
- ❷ Ensure all zippers are completely closed.
- ❸ Ensure the battery is fully charged. (The battery lasts approximately 45 minutes. As the battery weakens, the pressure in the Walking Ad Inflatable display is reduced, and the battery should be recharged.)
- ❹ Check for holes or tears in display fabric.

### *Blower motor is not working:*

- ❶ Ensure that the blower motor switch (located next to the battery pocket) is turned on.
- ❷ Ensure that the positive (red) and the negative (blue) connectors are properly attached to the battery.



# Walking Ad Inflatable™ Display

## User Manual

Each Walking Ad Inflatable™ display comes complete with a motor with blower, an ergonomically designed battery harness, two 12-volt batteries, and a charger. A carrying case is included for easy transport and storage.



**CAUTION:** Be careful when opening the carrying case. **DO NOT OPEN UPSIDE DOWN** to prevent the motor assembly from being dropped. Handle Walking Ad Inflatable displays with care. Please read entire manual carefully and follow instructions to ensure proper use.

## Installation Requirements

- 1 Depending on the product configuration, Walking Ad Inflatable displays generally require a wearer who is between 5'6" and 6' in height.
- 2 People suffering from asthma, epilepsy, or claustrophobia should not wear the Walking Ad Inflatable display.
- 3 Wearer should be dressed in lightweight, comfortable clothing and shoes.
- 4 Batteries should be fully charged prior to use.
- 5 Exhibition area should be free of sharp objects and obstacles.
- 6 Installation of the Walking Ad Inflatable display requires two people: the wearer and an additional person to help the wearer get into the display.

**CAUTION:** Once the wearer is secure inside the Walking Ad Inflatable display, an additional person may be needed to guide the wearer while mobile, as the wearer's vision may be limited.

### Warranty

The *Pioneer Line* warrants this product against defects due to faulty material or workmanship for a period of one year from the original date of purchase. The *Pioneer Line*, at its discretion, will repair or replace the product covered by the warranty.

This warranty does not cover damage to the product resulting from accident, misuse, improper care, or self-repairs.

All returns must be authorized and a Return Authorization Number is required. Shipping costs on warranty repairs are the responsibility of the purchaser.

This warranty gives you specific legal rights. You may also have other rights which vary from state to state.

**NOTE:** The warranty on the battery charger and the two 12-volt batteries is only an extension of the manufacturer's warranty. The *Pioneer Line* does not warranty those items.

## Maintenance

### Storage

Make sure the Walking Ad Inflatable display is completely dry before storing. **DO NOT STORE WET OR DAMP.** Storing the inflatable wet or damp will cause odors and mildew, and may void the warranty.

To store, pack the **battery harness** in the bottom of the carrying case. Loosely roll the **display**, place in the **carrying case**, and zip the carrying case closed.

**NOTE: Batteries and charger** should be packed **separately** from the battery harness and Walking Ad Inflatable display to protect the display against damage.

### Cleaning

If necessary, gentle cleaning can be done with a mild liquid soap and a clean cloth or sponge. **DO NOT SCRUB FABRIC.** Take special care when cleaning graphic areas.

### Repair Patches

Self-adhesive patches are provided. Cut a patch that is at least ½" larger than the size of the opening to be repaired. This allows the patch to overlap the opening. Peel the paper from the patch and carefully place it on the inside fabric of the Walking Ad Inflatable display. Lay a piece of clean cloth on top of the fabric and iron using medium heat. For larger openings, repeat the procedure on the outside fabric.

### Charging the Battery

Batteries last approximately 45 minutes each. Please refer to the manufacturer's instructions (which are enclosed with the batteries and charger) for operating and charging the battery.

## Set Up Continued

- 7 Secure the air duct in the air intake opening.
  - A. Locate the air intake opening on the inflatable.
  - B. Slip the air intake opening over the end of the air duct.
  - C. Pull the air duct to the end of the air intake opening to ensure an unobstructed intake of air.
  - D. Use Velcro® strap to secure the air duct in place.

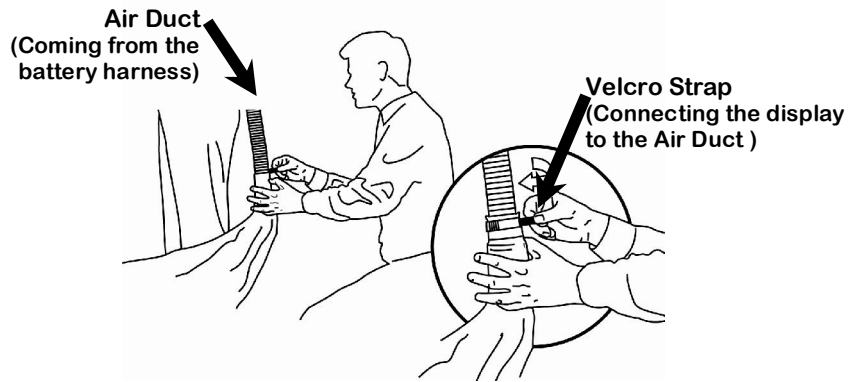

- 8 Pull the inflatable over wearer's head, and activate the blower motor.
  - A. Turn on the blower motor. (The switch is located next to the battery pocket.)
  - B. Once the blower motor is running zip up the inflatable to fully inflate.

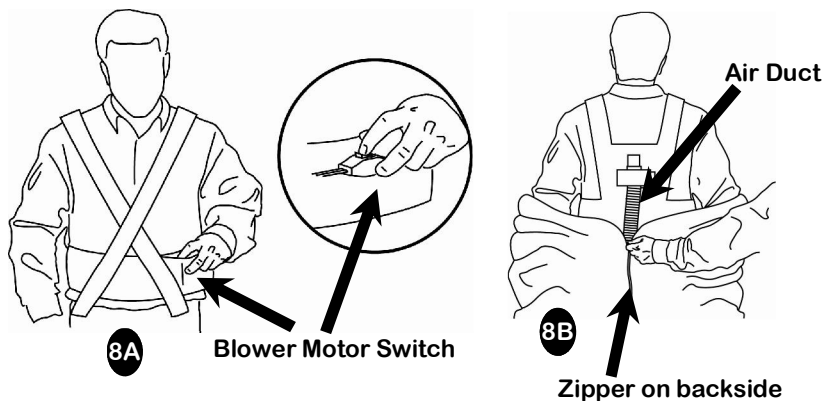

5

## Product Description

### Materials

Walking Ad Inflatable displays are skillfully crafted using high-quality fabric that is wrinkle-resistant, water-repellent and suitable for indoor and *moderate* outdoor use.

Walking Ad Inflatable displays include an ergonomically safe, lightweight battery harness (backpack style) designed to comfortably fit the wearer's body.

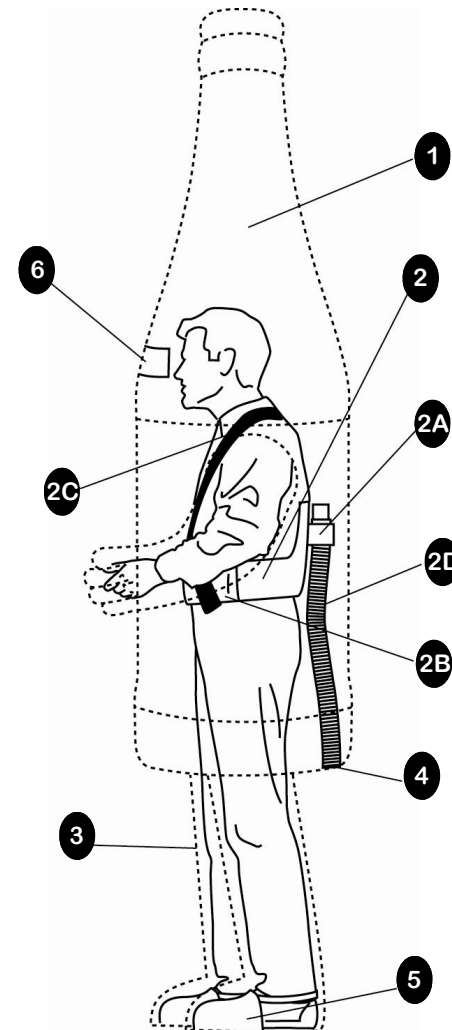

### Location of Components

- 1 Body of fabric
- 2 Battery harness (complete unit)
  - A. Electric blower motor
  - B. Battery pocket
  - C. Velcro® shoulder straps
  - D. Air duct
- 3 Legs
- 4 Air intake opening
- 5 Shoe pockets and Velcro adjustment straps
- 6 View window

2

# Set Up

Installation of the Walking Ad Inflatable™ display requires two people: the wearer and an additional person to help the wearer get into the display.

- 1 Install the 12-volt, 7-amp battery into battery pocket.
  - A. Insert the battery into the battery pocket.
  - B. Identify the positive (red) and negative (blue) connectors and insert them in both poles of the battery.
  - C. Secure the Velcro® flap.

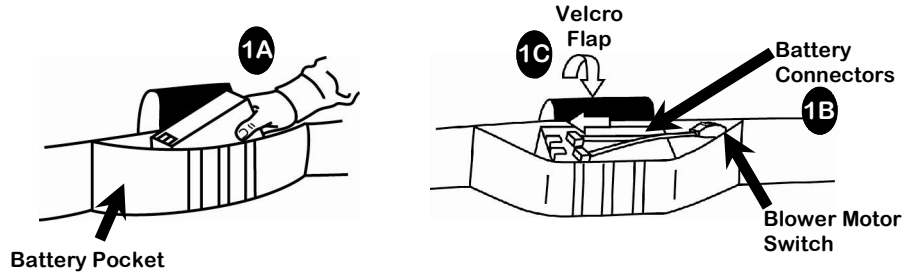

- 2 Put on the battery harness and adjust the Velcro straps.
  - A. Extend the battery harness straps completely.
  - B. Adjust the lower belt support to fit around the wearer's waist.
  - C. Adjust the Velcro shoulder straps by crisscrossing them on the front of the upper body.

**Note:** Make sure the harness fits snug against the wearer.

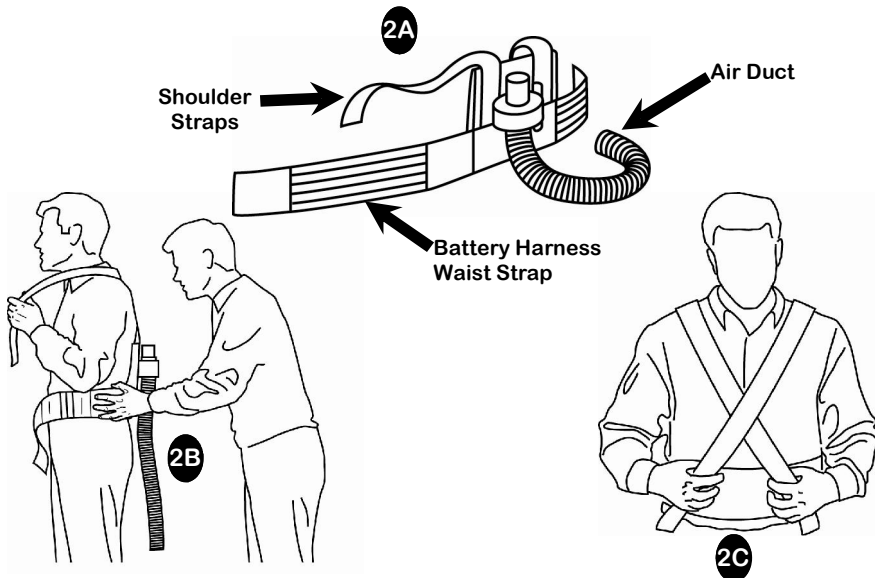

3

- 3 Lay the Walking Ad Inflatable display out on the floor with the backside up.
- 4 Slip feet into the shoe pockets and secure the Velcro straps around ankles.

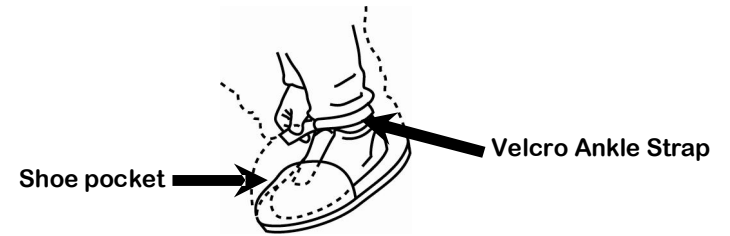

- 5 Pull the Walking Ad Inflatable display about halfway up torso and hold while the second person secures the air duct.

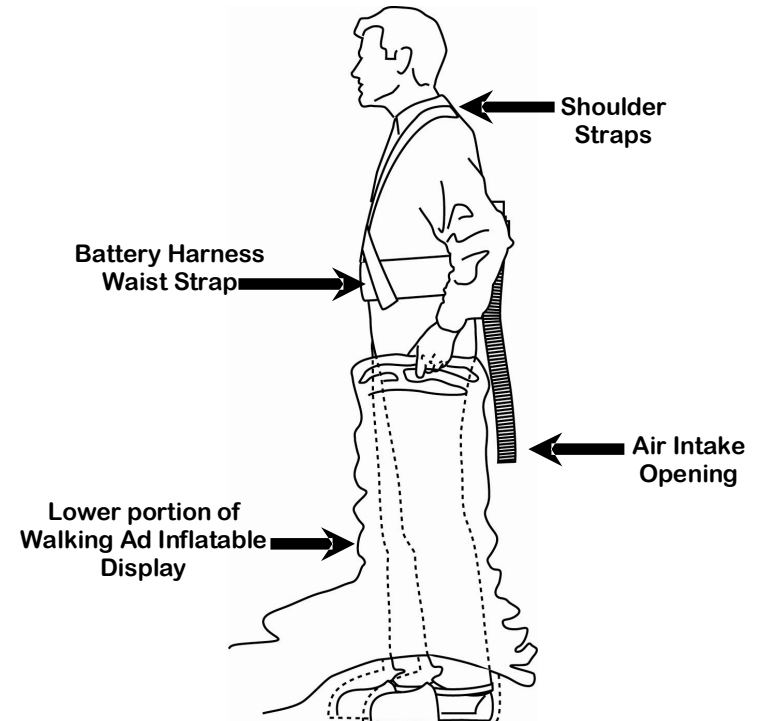

4